

PERSPECTIVE

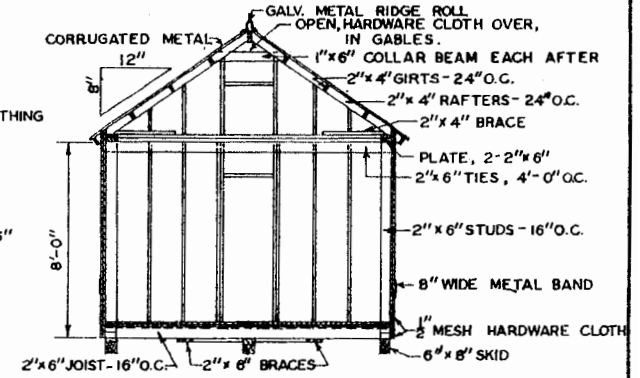

- BILL OF MATERIAL**
- 3 - 6" x 8" x 16'-0" - SKIDS
 - 24 - 2" x 6" x 16'-0" - STUDS AND RIDGE
 - 4 - 2" x 6" x 14'-0" - SIDE PLATES
 - 22 - 2" x 6" x 12'-0" - JOISTS, TIES, SPREADERS & AND PLATES.
 - 4 - 2" x 6" x 10'-0" - BRACES
 - 20 - 2" x 4" x 16'-0" - RAFTES, GIRTS, BRACES, ETC.
 - 120 - LIN. FT. $1\frac{1}{2}$ " x 4" - CORNER BOARDS, TRIM & CASING
 - 50 - LIN. FT. $1\frac{1}{8}$ " x 4" - CORNER BOARDS AND CLEATS
 - 800 FT. B.M., T.&G. - SHEATHING - WALLS, SUB-FLOOR, ETC.
 - 250 FT. B.M., T.&G. - FLOORING - FINISHED FLOOR & DOORS.
 - 600 FT. B.M. - DROP SIDING
 - 3 - 216 FT. ROLLS - WATERPROOF BUILDING PAPER.
 - 2 - 2" x 6" - DOOR SILLS.
 - 16 PIECES - 26 GA. - CORRUGATED METAL, 8'-0" LONG ROOF
 - 16 LIN. FT. - METAL RIDGE ROLL
 - 290 SQ. FT. - $\frac{1}{2}$ " MESH - HARDWARE CLOTH
 - 60 LIN. FT. - 28 GA. - GALV. METAL STRIPS - 8" WIDE.
 - 3 - 6" TEE HINGES.
 - 2 - 4" TEE HINGES.
 - 2 - HASPS.

NAILS, PAINT, AND LOG SILLS NOT INCLUDED IN ABOVE LIST.

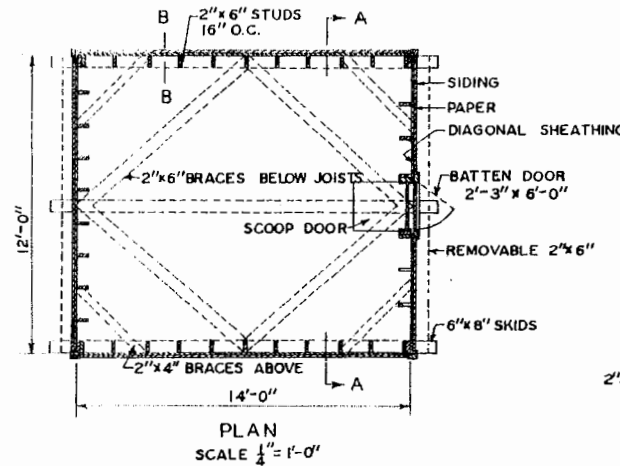
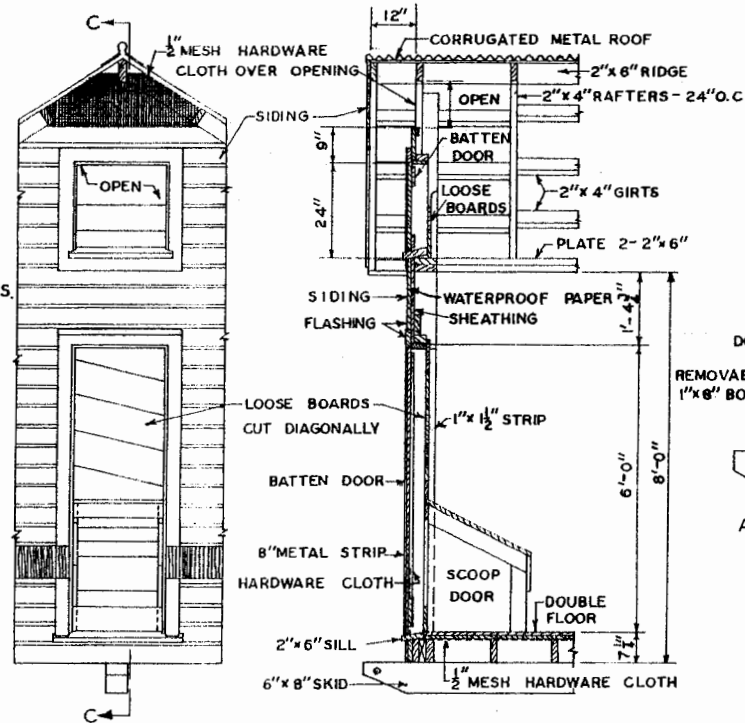

ELEVATION
BATTEN DOOR NOT SHOWN

DOOR DETAILS
SCALE $\frac{1}{2}'' = 1'-0''$

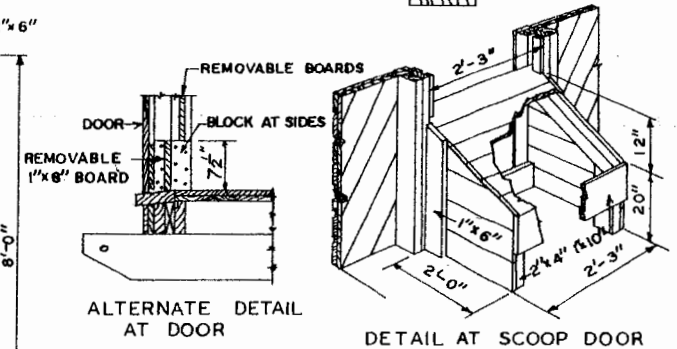
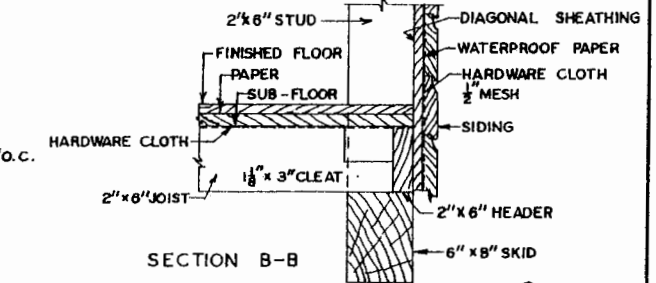

CAPACITY = 1000 BUSHELS



MOVABLE GRANARY (1000BU)

ENGINEER USDA	SCALE SHOWN
DRAWN BY	SHEET 1 OF 1
TRACED BY GM	RATE
	NO. 48-3

Disclaimer

This site makes available conceptual plans that can be helpful in developing building layouts and selecting equipment for various agricultural applications. These plans do not necessarily represent the most current technology or construction codes. They are not construction plans and do not replace the need for competent design assistance in developing safe, legal and well-functioning agricultural building system. The LSU Agriculture Center, the Mid-West Plan Service, the United States Department of Agriculture and none of the cooperating land-grant universities warranty these plans.